

CAR-MON SERIES PB PIPE BOOM

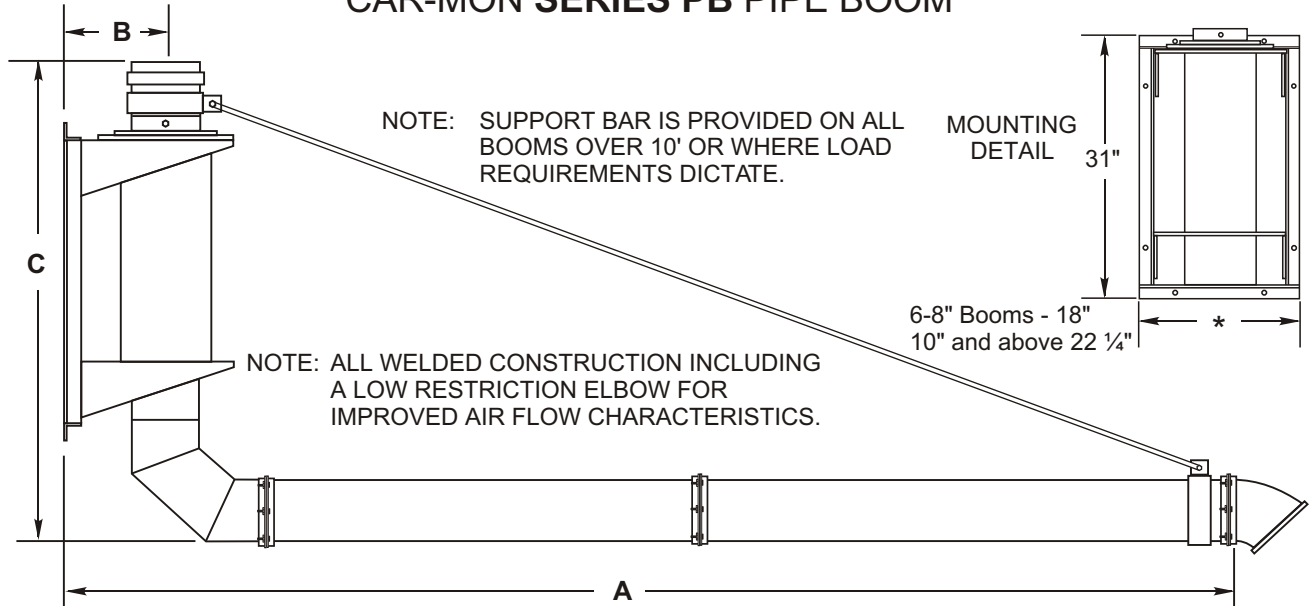

PIPE BOOM OPTIONS

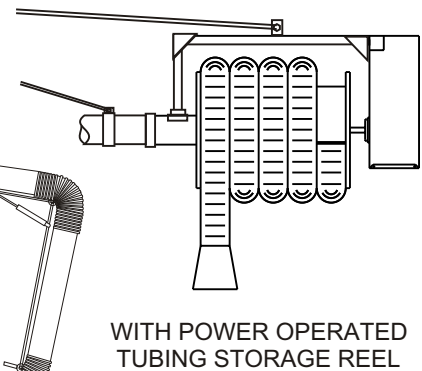
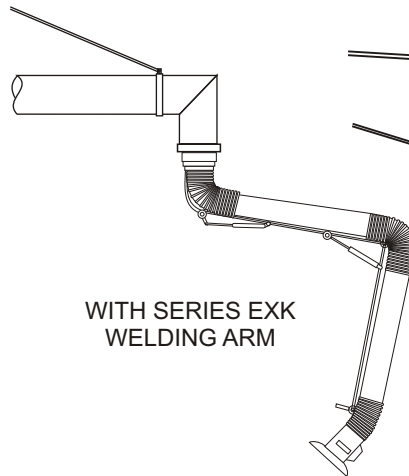
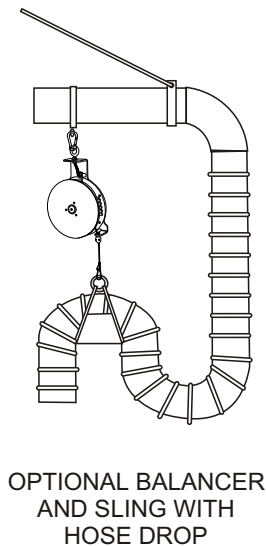
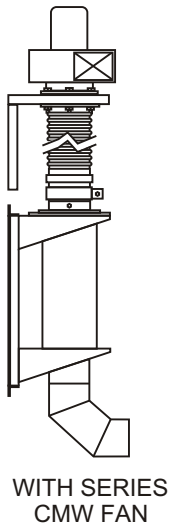

Note: Dimensional data subject to change

QTY.	MODEL NO.	DIA.	A	B	C	FAN INFORMATION						BOOM END OPTIONS				
						HP	VOLTAGE	CFM	S.P.	CW	CCW	DROP	ARM	REEL	HOOD	OTHER
	PB-6	6"		9"	50 1/2"		/ /									
	PB-8	8"		8 1/2"	58 1/2"		/ /									
	PB-10	10"		9 1/2"	62 1/2"		/ /									

SPECIFICATION: Tubular boom shall be the standard product of a United States exhaust system manufacturer and be of all welded construction utilizing 1/8" wall, seamless mechanical tubing of specified diameter with low restriction 90° elbow. It shall be of the length shown on drawings and equipped with a steel angle iron flange to which the exhaust extraction assembly will attach with mating flange gasket and bolts. The mounting base and rotating bearing assembly shall be of welded construction utilizing a 1 minimum 1/2" x 1 1/2" 3/16" structural angle iron mounting frame, with 1/8" back plate and two formed bearing platforms with integral steel tubular support sleeve. The bearing assemblies are to be comprised of ultra high density, lubricative synthetic material of an appropriate load bearing capacity with an upper structural angle locking flange and ball bearing race; a stainless steel swivel is to be supplied for connecting to system ducting providing bind free rotation. Pipe Boom shall be Series PB, as manufactured by Car-Mon Products, Inc., Elgin, Illinois.